

F960 Expanded Beam Connector

Fiber Optic Connectors

F960 expanded beam fiber optic connectors are fully compatible with other Eurocom type II legacy connectors. Designed specifically for military tactical communications, the F960 connector is available with 2, 4, 8 or 12 multimode optical channels and features a unique “pinless” alignment technique providing flat, easily cleanable mating surfaces.

The connectors are terminated using an epoxy-polish ferrule termination process with standard fiber optic termination tools and equipment. The terminated ferrules are simply inserted into the

expanded beam housing and fixed in place via a spring and cover-plate. Ferrule alignment to the lenses is achieved automatically by the unique optical arrangement developed and patented by Cinch-Fibreco.

In the event of the connector suffering severe damage in use, the connector design enables replacement of the expanded beam insert / connector front body and grip ring without the need to re-terminate the fibers. Typically, an expanded beam insert can be replaced within 30 minutes in field conditions.

The F960 expanded beam connectors offer high performance, flexibility and cost effectiveness, combined with a simple termination process allowing rapid in-field termination and repair where compatibility with legacy products is essential.



Key Features & Benefits

- Eurocom type II compatibility
- 2, 4, 8 or 12 Multimode optical channels
- Low insertion loss
- Field terminable / repairable
- Hermaphroditic design
- Fully sealed (IP68)



Fibreco
12 Flitch Industrial Estate
Chelmsford Road
Great Dunmow, Essex CM61XJ UK

+44 (0)1371 873 334
sales@fibreco.co.uk
cinch.com

F960 Expanded Beam Connector

Maxi Expanded Beam Connector - Outline Specification

Insertion Loss	Multimode 50/125 Fiber at 850nm / 1300nm : -1.5dB maximum (typical -1.0dB)*
Durability	3000 Matings minimum
Operating Temperature	-40°C to +85°C
Storage Temperature	-55°C to +85°C
Water Immersion	5m
Free Fall Resistance	500 Falls from 1.2m height
Vibration	10-500Hz, 3 directions, 0.75mm amplitude@ 10g acceleration
Bump	4000 bumps @ 40g acceleration
Crush Resistance	6.7kN
Corrosion Resistance	500 Hours Salt Spray (Anodised aluminum shell)
Cable Retention	1500N (Cable Dependant)
Weight (approx)	Plug: 520g
Connector Shell Material / Color	Bulkhead: 430g Aluminum, black anodised & Stainless Steel Grip & boot: Black

*Measurements against reference—random mate performance in line with MIL83526

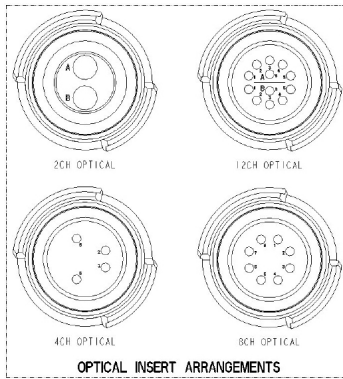

Plug Connector

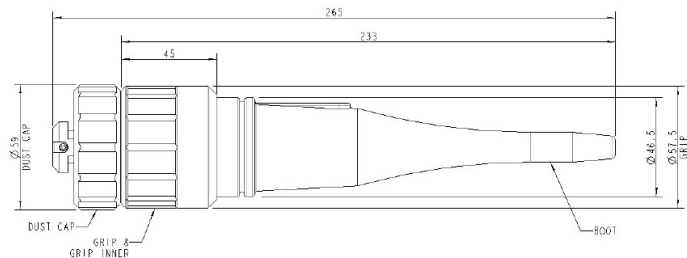

Bulkhead Connector Flange Mount

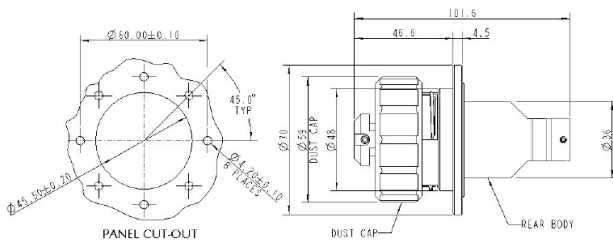

Bulkhead Connector Jam-Nut Mount

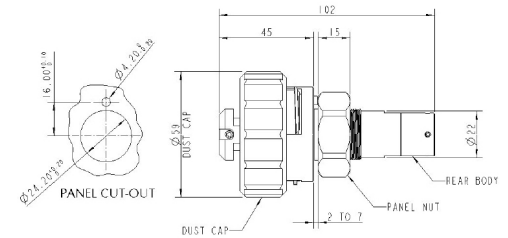

+44 (0)1371 873 334
sales@fibreco.co.uk

cinch.com